

T3CR180M-4 18,5KW 400/690V B5

Single-phase asynchronous motor in aluminum

Motor type T3CR180M-4 18,5KW 400/690V B5
 Brand BUSCK
 Item number 93041802T

| Voltage V | Power kW | Frequency Hz | Current A | Speed rpm |
|-----------|----------|--------------|-----------|-----------|
| 400 | 18,5 | 50 | 33,5 | 1460 |
| 690 | 18,5 | 50 | 19,3 | 1460 |
| 460 | 21,28 | 60 | 33,5 | 1752 |

| | | | |
|----------------------------------|--------------|--------------------------|--------------|
| Duty | S1 | Efficiency class | IE3 |
| Enclosure | IP55 | Efficiency, load 100% | 92,6 |
| Insulation class | F | Efficiency, load 75% | 93,6 |
| Cooling | IC411 (TEFC) | Efficiency, load 50% | 93 |
| Max. ambient temp. | 45°C | Power fact, load 100% | 0,86 |
| Max. temp. rise | 80 K | Painting | Standard |
| Max altitude, masl | 1000 | Color | RAL 9005 |
| Torque, Nm | 121,01 | Weight kg | 169,4 |
| Starting torque ratio | 2,5 | Sound pressure Lp dB(A) | 76 |
| Pull up torque ratio | 1,8 | Bearing DE | 6311 C3 |
| Pull out torque ratio | 3 | Bearing NDE | 6311 C3 |
| Starting current ratio | 9 | Balance grade | Normal |
| Winding protection | Thermistors | Inertia kgm ² | 0,1553 |
| This motor has DNV type approval | | Cable entries | 2xM32, 1xM16 |

Note IE3

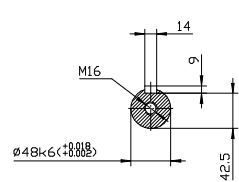
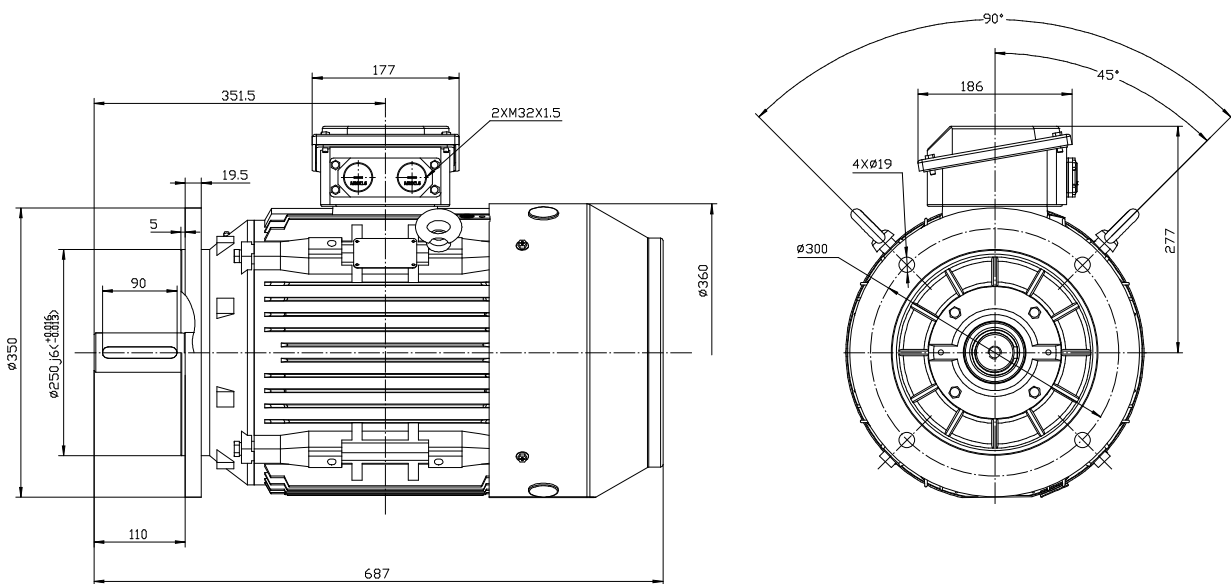

TC 180M B5



Busck & Co AB
 Gamla Riksvägen 14
 428 32 Göteborg
 Sweden
 556027-1990
 info@busck.se

Busck & Co ApS
 Postboks 108
 0900 København C
 Denmark
 info@busck.eu

Busck AS
 Skibåsen 35C
 4636 Kristiansand
 Norway
 info@busck.no